

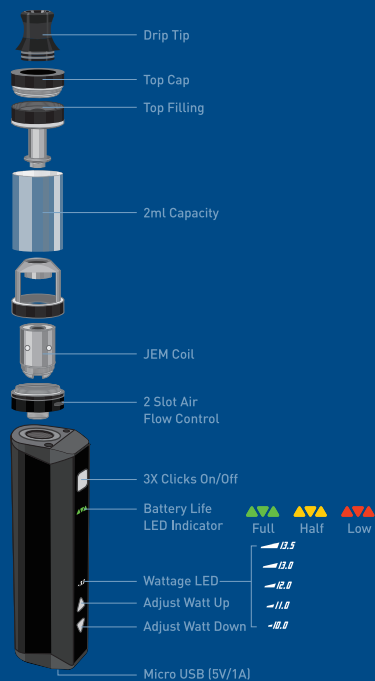

INNOKIN

JEM

QUICK START GUIDE



FLIP FOR MORE INFO

HOW TO FILL JEM TANK

- 1 ATTACH TANK
- 2 UNSCREW CAP AND TOP FILL

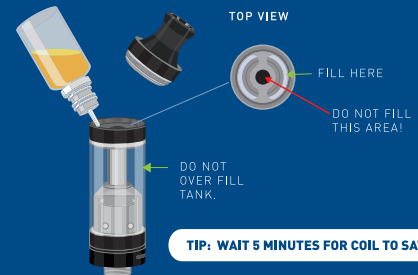

TIP: WAIT 5 MINUTES FOR COIL TO SATURATE!

REPLACE THE COIL



TIP: MAKE SURE THERE IS NO ELIQUID IN THE TANK BEFORE REMOVING THE COIL!

TIPS AND BEST PRACTICES

- DO NOT LET BATTERY RUN EMPTY. RECHARGE WHEN LED IS RED.
- USE THE PROVIDED USB CABLE AND CERTIFIED WALL CHARGER TO CHARGE THE BATTERY.
- DO NOT LEAVE BATTERY UNATTENDED WHILE CHARGING.
- TO CLEAN TANK:
 - UNSCREW TOP CAP AND REMOVE COIL
 - FILL TANK WITH WARM WATER AND SCREW TOP CAP ON
 - GENTLY SHAKE, WITH WATER INSIDE
 - UNSCREW CAP AND EMPTY WATER; REPEAT IF NECESSARY
 - AIR DRY COMPLETELY AND READY TO USE

SUPPORT

- facebook.com/Innokin.Technology
- instagram.com/innokintechnology
- twitter.com/innokintech
- reddit.com/r/innokin
- support@innokin.com