

USER MANUAL

itaste MVP 2.0

Welcome to the iTaste MVP

An Advanced Personal Vaporizer from Innokin Technology with Variable Voltage , Variable Wattage and Passthrough Charging.

Congratulations on purchasing this original iTaste MVP & Welcome to the Future.

First of all, please ensure that your iTaste MVP is a Real Innokin Technology product.

To verify that this iTaste MVP is a real Innokin Technology device please:

- 1) Locate and Scratch to reveal your iTaste MVP Unique Authorization number which is included on a label on the reverse of the packaging.
- 2) Visit the Official Innokin Technology website at <http://www.innokin.com>.
- 3) Enter the Unique Authentication number in the Authentication field.
- 4) Verify your iTaste MVP is a Real Innokin Technology.

If you have any questions or suggestions we would like to invite you to please write to us at Support@innokin.com. We are looking forward to hearing from you. Join our Innokin FaceBook Page: www.facebook.com/Innokin.Technology for the latest information and to win great prizes!!

WARNING:

Please read this section carefully to ensure you receive maximum benefits from your iTaste MVP and enjoy vaping with it in the most safe and effective ways possible.

1. This Advanced Personal Vaporizer may be used with e-liquids that contain nicotine. **Please check with your e-liquid provider.** This product is only intended for use by adults of legal smoking age (18+) and should not be used by children, women who are pregnant or breastfeeding, or persons with or at risk of heart disease, high blood pressure, diabetes or taking medicine for depression or asthma, or who otherwise may be sensitive to nicotine. Nicotine is addictive and habit forming, and it is very toxic by inhalation, in contact with the skin or eyes, or if swallowed. Ingestion of the non-vaporized concentrated e-liquid ingredients can be poisonous. Keep away from children and pets.
2. This Advanced Personal Vaporizer may be used with e-liquids that contain nicotine, a chemical known to the State of California to cause birth defects or other reproductive harm. **Please check with your e-liquid provider. (For products sold in California.)**
3. This Advanced Personal Vaporizer is only designed to be used with high quality e-liquid. **Please check with your e-liquid provider.** This device is not intended for use with loose tobacco leaf or herbal substances.
4. This Advanced Personal Vaporizer has not been evaluated by the Food and Drug Administration and is not intended to treat, mitigate, prevent or cure any disease or condition. This product is not intended for use as a smoking cessation device.

5. This product is intended for use with the charger provided with the unit. We recommend you always use a high quality 5V 500mA USB wall charger (CE/UL Certified). Use of unauthorized chargers may lead to overheating and possible burning of items in contact with the unit. Innokin Technology is not responsible for battery and charger explosions, fires or malfunctions due to the use of a low-quality charger. This product does not come included with any wall charger.
6. This Advanced Personal Vaporizer does not come included with car charger or car charger adapter. This device is not designed for use with a car charger. Use of unauthorized chargers may lead to overheating and possible burning of items in contact with the unit.
7. All empty clearomizers must be disposed of properly and out the reach of children and pets.
8. This Advanced Personal Vaporizer includes small parts such as the mouth piece. Always keep any small parts out of reach of children and pets to prevent swallowing or other harm.
9. Obey local laws or regulations regarding Electronic Cigarettes when vaping. If you are in an area where there are any bans or potential dangers, please do not use your Advanced Personal Vaporizer.
10. Do not misuse, mishandle or store your Advanced Personal Vaporizer improperly. Even though it is made of high quality stainless steel it may become damaged when dropped or otherwise mishandled.
11. Do not drop, throw, or mishandle your Advanced Personal Vaporizer as the outer shell or inner components may become damaged. If the shell of the device becomes damaged or the structural integrity of the battery becomes compromised, discontinue use immediately and contact your Authorized Innokin Technology Vendor.

12. In order to prolong the operation of your Advanced Personal Vaporizer, please do not place or store in excessively hot or cold environments.
13. Your Advanced Personal Vaporizer is not waterproof. Keep it dry at all times. Do not submerge this device or expose it to moisture.
14. Keep your Advanced Personal Vaporizer away from sources of excessive heat or cold as damage may occur.
15. Do not attempt to repair the unit by yourself as damage or personal injury may occur.
16. In order to guarantee the normal functioning of your Advanced Personal Vaporizer, and maximize the pleasure of vaping, we strongly advise that you charge the battery when the power level drops below 10 percent.
17. Do not leave the battery depleted for long periods of time between recharging or the battery capacity may be decreased.
18. Do not leave this device unattended while charging.
19. If the device becomes excessively hot, discontinue use immediately and contact your Authorized Innokin Technology Vendor.
20. If the device will not power off, discontinue use immediately and contact your Authorized Innokin Technology Vendor.
21. If the device functions in a way which is not stated in the manual contact your Authorized Innokin Technology Vendor.
22. As this device has an internal Lithium Ion Battery, the lifespan of the product will be limited.

Warranty

Please consult with Innokin official distributors for their warranty and return policy. Innokin's warranty does not apply to products purchased through third party vendors.

iTaste MVP is a microprocessor controlled VV/VW personal vaporizer that lets you easily adjust the voltage and wattage with just a few button presses.

Specifications:

Size : 23*41*107mm

Operating Voltage : 3.3V-5.0V

Operating Wattage : 6.0W-11.0W

Battery capacity : 2600mAh

Main Features:

➤ Variable Voltage:

Voltage can be adjusted from 3.3 – 5.0 volts in .1 volt increments.

➤ Variable Wattage:

Wattage can be adjusted from 6.0 – 11.0 W in .5 watts increments.

➤ Ohms meter :

Reads resistance of your atomizer/cartomizer/clearomizer.

➤ Puff Counter:

Puff counter will record the number of puffs you have taken. Either press “ P ” button or “ U ” button 1 second to check puffs, The Puff Counter will be cleared when the device is turned off.

➤ Short Circuit/Atomizer Protection:

Short Circuit/Atomizer Protection protects the iTaste MVP against shorted atomizers.

➤ Over-Discharge Protection:

The iTaste MVP monitors the battery voltage and will automatically turn off when the battery is discharged.

➤ Battery Level Indicator:

The iTaste MVP battery capacity is displayed via green, yellow and red LED lights.

Green = Fully Charged

After the iTaste MVP is fully recharged, the LED lights will turn off.

Yellow = Half Discharged

Red = In need of charging

➤ Large battery capacity:

iTaste MVP built-in 2600 mAh polymer Li-Ion rechargeable battery.

➤ High compatibility 510 connector:

Thread fit iClear10, iClear16 , iClear30 etc.

➤ ON/OFF battery switch:

Quickly clicking “⏻” three times will enable or disable the battery. Once enabled, holding down the button will activate the battery.

This safety feature prevents the atomizer from turning on while it's in your pocket or bag and it prevents any settings from getting changed without you knowing.

➤ 10 seconds cutoff:

If the button is held down for 10 seconds or longer, the iTaste MVP will shut itself off until the button is released and pressed again.

➤ Passthrough:

The iTaste MVP uses a built in Micro USB Port. You can recharge it with a Micro USB cable. It can also work as a pass-through for use while charging.

➤ Remembers last set voltage or wattage :

Remembers last set voltage or wattage when the battery is turned off and then back on.

➤ Built-in 3 digit display :

Digital display shows Ohms meter, Voltage / Wattage setting, number of puffs taken since last time the battery was turned off.

Portable power source for electronic products

Turn ON the small pin switch in bottom of iTaste MVP, connect cable into USB OUTPUT port (DC 5V , maximum output current 0.5A, the 3 most popular power connectors for iPhone / iPods, MiniUSB (Motorola / Blackberry), a Micro USB (Motorola / Nokia / LG / Samsung). Turn OFF the small pin switch when finish charged your electronics .

OPERATION GUIDE

There are three main buttons on the iTaste MVP: “⏻” button, “P” button and “U” button; all the functions can be activated by using those three buttons to change settings in a single step, without the use of a menu system. Your chosen mode will be displayed on the digital screen.

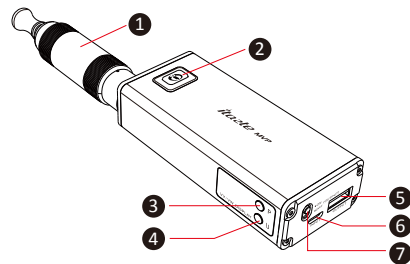

NO.	Function description
1	iClear dual coil clearomizer
2	ON/OFF Power button: The iTaste MVP battery capacity is displayed via green, yellow and red LED lights. Green = Fully Charged Yellow = Half Discharged Red = In need of charging
3	“P” button: VW
4	“U” button: VV
5	Portable power source for electronic products
6	Turn ON this small pin switch when use as power source for electronic products .
7	Recharge iTaste MVP with a standard USB Micro cable plug, it can also work as a passthrough for use while charging.

➤ ON/Off:

Quickly clicking the “⏻” button three times will enable or disable the battery. Once enabled, holding down the button will activate the battery.

➤ Variable Voltage Mode :

Press the “U” button for 3 seconds to enter variable voltage mode. The screen will show you the Puff counter first followed by the last adjustment (The last adjustment may be a voltage or wattage setting), after showing the last adjustment, the iTaste MVP will enter variable voltage mode. Voltage can be adjusted from 3.3 to 5.0 volts in .1 volt increments by pressing the “U” button.

➤ Variable Wattage Mode :

Press the “P” button for 3 seconds to enter variable wattage mode. The screen will show you the Puff counter first followed by the last adjustment (The last adjustment may be a voltage or wattage setting), after showing the last adjustment, the iTaste MVP will enter variable wattage mode. Wattage can be adjusted from 6.0 to 11 watts in. 5 watt increments by pressing the “P” button.

➤ Ohms Meter & Battery Level Indicator & Puff Counter:

Hold both the “P” and “U” buttons simultaneously for 2 seconds. The screen will show a series of readings, the first being the resistance of the attached load (Rx.x, for example R2.2), the second being the battery voltage, the third being the number of puffs since the device was last turned off and the fourth being the last set voltage or wattage. If no load is attached the display will show “NON”.

If you wish to check the number of puffs taken since the iTaste MVP was last turned off, you can also hold either the “P” or the “U” button to display the Puff Counter which will be followed by the display of current mode (VV mode or VW mode). In this state, you can also adjust the voltage or wattage by pressing the “P” or “U” button.

LED Light Blinking Mode:

The LED light will blink in different colors to indicate the current battery voltage.

1. Red LED light = battery voltage is lower than 3.61V
2. Yellow LED light = battery voltage between 3.61V and 3.75V
3. Green LED light = battery voltage is more than 3.75V
4. Red LED will keep blinking for 8 seconds when battery capacity is lower than 3.3V and the device will turn off automatically.
5. Red LED light will stay on for 5 seconds when a load short circuit is detected or the current of the coil is more than 3.5A, then no vapor will be produced.
6. If you take a drag for longer 10 seconds, the battery will stop it's output, the RED light will blink 10 times, and the iTaste MVP won't continue to work until you press the power button again.

Notes:

Replace or refill the cartridge if vapor volume decreases. The manufacturer is not responsible for a damaged atomizer, cartomizer or clearomizer. Driving them with too much power for too long or running them dry can burn them out. We recommend you start with a low voltage setting and work your way up until when you find the right setting for your atomizers, cartomizers or clearomiers. Never use your iTaste MVP without an atomizer,

cartomizer or clearomizer. Connecting to a volt meter without the load required for high voltages can damage the device.

Don't abuse your iTaste MVP although it's made of metal; You can damage it by dropping it. Set lower voltages /wattage for lower Ohms, higher voltage/wattage for higher Ohms.

CHARGING ITASTE MVP



When plug in, the LED light will blink from red to yellow to green, then stay on current battery capacity level, for example, if your battery current capacity yellow, then LED light will stay on Yellow, then change to Green. After the iTaste MVP is fully recharged, the LED lights will turn off.

Recharge iTaste MVP with a standard USB Micro cable plug, it can also work as a passthrough for use while charging.

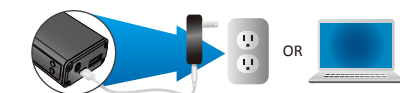

Plug the USB cable into iTaste MVP's input and plug the other end into a power source.



The color of the LED light indicates the remaining battery life. After the iTaste MVP is fully recharged, the LED lights will turn off.

